



Meadow Road | London | SW8 1PP

£1,850 pcm

- Vauxhall
- Two double bedrooms
- Split level with loft
- Victorian features
- Interior design
- Available now
- Close to transport
- Beautifully presented
- River Walk
- Vauxhall Park



Stylish split level loft apartment, located in Zone one, Vauxhall, close to excellent transport links, Vauxhall Park and Thames Walk. Two double bedrooms with beautiful interior design, furnished and available to let immediately. Well proportioned, light and well equipped.

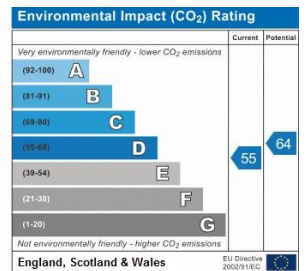
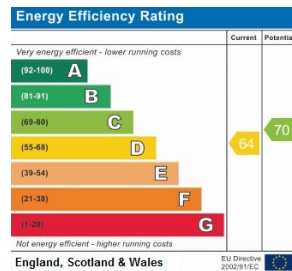
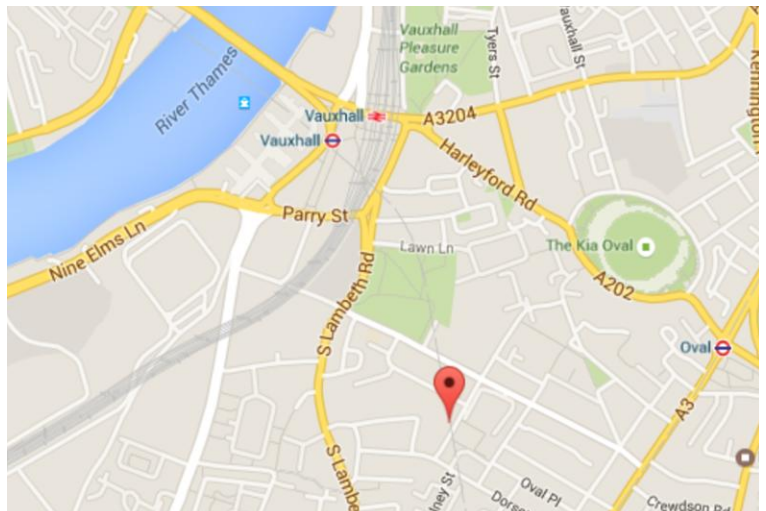

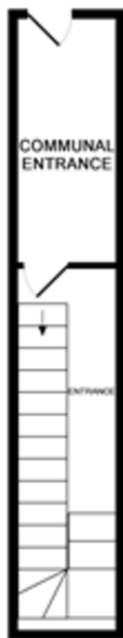

GROUND FLOOR
APPROX. FLOOR
AREA 167 SQ.FT.
(15.5 SQ.M.)

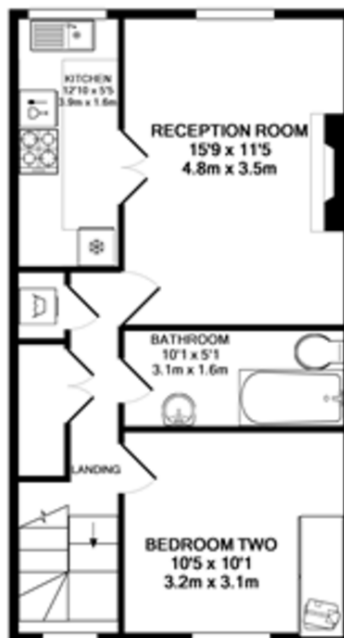

2ND FLOOR
APPROX. FLOOR
AREA 524 SQ.FT.
(48.6 SQ.M.)



TOP FLOOR
APPROX. FLOOR
AREA 526 SQ.FT.
(48.8 SQ.M.)

TOTAL APPROX. FLOOR AREA 1217 SQ.FT. (113.0 SQ.M.)

Whilst every attempt has been made to ensure the accuracy of the floor plan contained here, measurements of doors, windows, rooms and any other items are approximate and no responsibility is taken for any error, omission, or mis-statement. This plan is for illustrative purposes only and should be used as such by any prospective purchaser. The services, systems and appliances shown have not been tested and no guarantee as to their operability or efficiency can be given
Made with Metropix ©2015

Viewing Arrangements

Strictly by appointment

Contact Details

121 Denmark Hill

London

SE5 8EN

www.urbanvillagehomes.co.uk

lettings@urbanvillagehomes.com

020 3519 9121

Agents Note: Whilst every care has been taken to prepare these sales particulars, they are for guidance purposes only. All measurements are approximate and are for general guidance purposes only and whilst every care has been taken to ensure their accuracy, they should not be relied upon and potential buyers are advised to recheck the measurements