



Meadow Road | London | SW8 1PP

Share of Freehold

£585,000

- Vauxhall, zone one
- Two double bedrooms
- Split level with loft
- Victorian features
- Share of freehold
- Vauxhall Tube
- Oval Tube
- Thames River Walk
- London Eye
- London attractions walking distance



Stylish split level loft apartment, located in a popular residential area in the heart of Vauxhall. The apartment is arranged over the top floor and loft conversion, providing two double bedrooms, lounge, kitchen and bathroom, good storage and natural light. The apartment has a share in the freehold (with the 2 other flats) in a Victorian house conversion. The apartment is located within walking distance of Vauxhall tube and 1 minute to Vauxhall Park. Thames River Walk, London Eye and many London attractions are close-by. Currently rented out on an assured shorthold tenancy, sold with no onward chain, vacant from January.

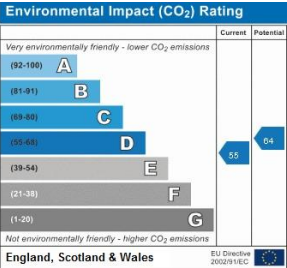
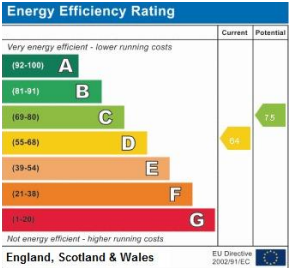

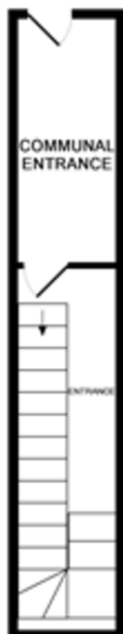

GROUND FLOOR
APPROX. FLOOR
AREA 167 SQ.FT.
(15.5 SQ.M.)

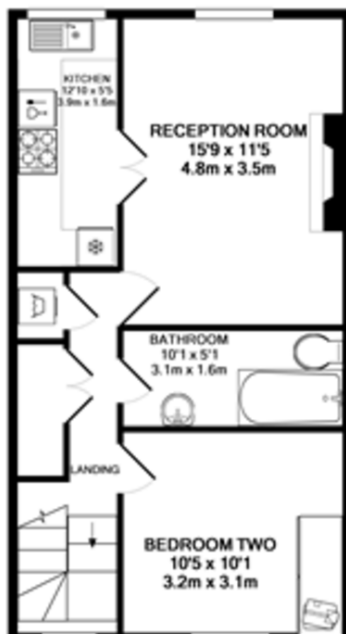

2ND FLOOR
APPROX. FLOOR
AREA 524 SQ.FT.
(48.6 SQ.M.)

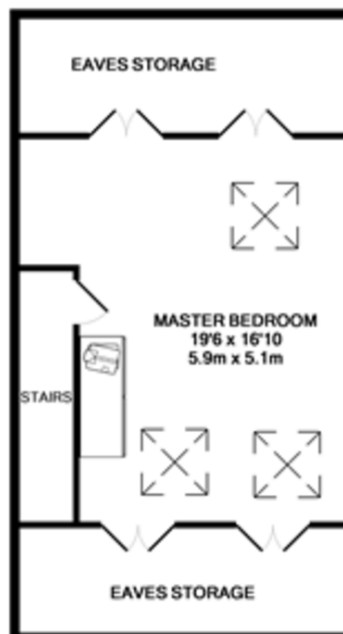

TOP FLOOR
APPROX. FLOOR
AREA 526 SQ.FT.
(48.8 SQ.M.)

TOTAL APPROX. FLOOR AREA 1217 SQ.FT. (113.0 SQ.M.)

Whilst every attempt has been made to ensure the accuracy of the floor plan contained here, measurements of doors, windows, rooms and any other items are approximate and no responsibility is taken for any error, omission, or mis-statement. This plan is for illustrative purposes only and should be used as such by any prospective purchaser. The services, systems and appliances shown have not been tested and no guarantee as to their operability or efficiency can be given.
Made with Metropix ©2015

Viewing Arrangements

Strictly by appointment

Contact Details

121 Denmark Hill

London

SE5 8EN

www.urbanvillagehomes.co.uk

sales@urbanvillagehomes.com

020 3519 9121

Agents Note: Whilst every care has been taken to prepare these sales particulars, they are for guidance purposes only. All measurements are approximate and for general guidance purposes only and whilst every care has been taken to ensure their accuracy, they should not be relied upon and potential buyers are advised to recheck the measurements.