



Camberwell Green | London | SE5
7BJ

£1,760 pcm

- One double bedroom
- Recently renovated
- High spec
- Modern Kitchen
- New bathroom
- Excellent location
- Denmark Hill Station
- Local amenities
- Excellent bus routes
- Kings College Hospital



Modern one bed flat on Camberwell Green. Recently renovated to a very high standard, separate kitchen / living area with room to eat in the kitchen all new furnishings through out, high spec modern bathroom and large double bedroom. Perfect for a professional couple or single occupant. Fantastic local amenities in and around Camberwell Green, whilst Herne Hill, Lordship Lane and Peckham are all easily accessible on foot. Ideal for anybody working at nearby King's College Hospital. Denmark Hill station is a short stroll away, with trains to Victoria in under ten minutes and London Bridge in under twenty.



Energy Efficiency Rating		
	Current	Potential
Very energy efficient - lower running costs		
(92+) A		
(81-91) B		
(69-80) C	75	79
(55-68) D		
(39-54) E		
(21-38) F		
(1-20) G		
Not energy efficient - higher running costs		

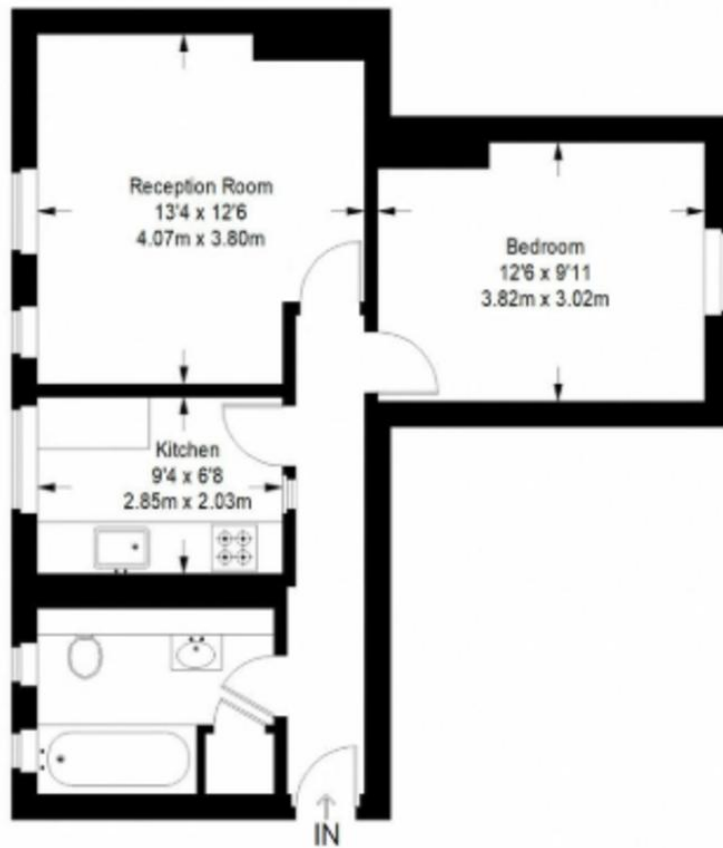

Third Floor = 480 sq ft

Approximate Gross Internal Area
THIRD FLOOR = 480 sq ft / 44.59 sq m
Total = 480 sq ft / 44.59 sq m



This plan is for layout guidance only. Not drawn to scale unless stated. Windows and door openings are approximate. Whilst every care is taken in the preparation of this plan, please check all dimensions, shapes and compass bearings before making any decisions reliant upon them. (ID357409)

Viewing Arrangements

Strictly by appointment

Contact Details

121 Denmark Hill

London

SE5 8EN

www.urbanvillagehomes.co.uk

lettings@urbanvillagehomes.com

020 3519 9121

Agents Note: Whilst every care has been taken to prepare these sales particulars, they are for guidance purposes only. All measurements are approximate are for general guidance purposes only and whilst every care has been taken to ensure their accuracy, they should not be relied upon and potential buyers are advised to recheck the measurements